



Silindirik Tip Tork Sensörleri

Annular Transducers



- » ± 0.5 tork ölçüm hassasiyeti.
- » 300.000 N.m'ye kadar tork ölçüm imkanı.
- » BS7882:2008 standardında Class1 derecelendirme.
- » Sensörler UKAS akrediteli kalibrasyon belgelidir.
- » Saat yönü kalibrasyon standart, ters yöne opsiyonel.
- » Norbar tork sensörleri kimlik bilgileri taşıyan çipe sahiptir.
- » Farklı marka görüntüleyicilerle sorunsuz olarak kullanılabilir.
- » Torsiyon harici kuvvetler tork ölçümlerini etkilemez.

- » ± 0.5 torque measurement accuracy.
- » Torque measurement capability up to 300.000 N.m.
- » Guaranteed classification to BS7882:2008.
- » Supplied with UKAS accredited calibration certificate.
- » Clockwise calibration standard, reverse optional.
- » Norbar transducers have a smart chip with ID information.
- » Works with different brand displays.
- » Non-torsional forces do not affect torque measurements.

Parça Part	Ölçüm Aralığı Measurement Range		Sürücü Sq. Drive	Uyumlu Cihazlar Compatible Multipliers	Ölçüler (mm) Sizes			Ağırlık Weight
	N.m	Lbf.ft			inç	#	A	
50753.LOG	270 - 2.700	-	1"	HT/ET/PTM-92	120.5	73	-	-
50793.LOG	400 - 4.000	-	1"	HT/ET/PTM-92	120.5	73	-	-
50755.LOG	450 - 4.500	-	1.1/2"	HT/ET/PTM-119	199	86	-	-
50756.LOG	600 - 6.000	-	1.1/2"	HT/ET/PTM-119	199	86	-	-
50666.LOG	100 - 1.000	-	-	PT-72/HT-72	117	73	-	1.5
50667.LOG	150 - 1.500	-	-	PT-72/HT-72	117	73	-	1.5
50668.LOG	200 - 2.000	-	-	PT-72/HT-72	117	73	-	1.5
50663.LOG	600 - 6.000	-	1.1/2"	HT60/PT5500	88	120	-	2.5
50638.LOG	100 - 1.000	-	3/4"	PT1/PT1A/PT2	61	108	99.6	1.4
50648.LOG	-	100 - 1.000	3/4"	PT1/PT1A/PT2	61	108	99.6	1.4
50639.LOG	150 - 1.500	-	1" HD Type	HT2/PT1/PT1A/PT2	61	108	99.6	1.4
50649.LOG	-	150 - 1.500	1" HD Type	HT2/PT1/PT1A/PT2	61	108	99.6	1.4
50640.LOG	250 - 2.500	-	1" HD Type	HT5/PT5	79.5	119	99.06	2.6
50650.LOG	-	250 - 2.500	1" HD Type	HT5/PT5	79.5	119	99.06	2.6
50641.LOG	350 - 3.500	-	1" HD Type	HT5/PT5	79.5	119	99.06	2.6
50700.LOG	350 - 3.500	-	1.1/2"	HT6/PT6	79.5	119	99.06	2.8
50643.LOG	500 - 5.000	-	1.1/2"	HT7/PT7	83	144	125	3.63
50652.LOG	-	500 - 5.000	1.1/2"	HT7/PT7	83	144	125	3.63
50644.LOG	1.000 - 10.000	-	1.1/2"	HT9/PT9	90	184	152.4	6.26
50653.LOG	-	700 - 7.000	1.1/2"	HT9/PT9	90	184	152.4	6.26
50645.LOG	2.000 - 20.000	-	2.1/2"	HT11/PT11	-	-	-	7.9
50654.LOG	-	1.500 - 15.000	2.1/2"	HT11/PT11	-	-	-	7.9
50764.LOG	3.500 - 35.000	-	2.1/2"	HT12/PT12	-	-	-	-
50765.LOG	-	2.500 - 25.000	2.1/2"	HT12/PT12	-	-	-	-
50646.LOG	5.000 - 50.000	-	2.1/2"	HT13/PT13	126	315	290	30.8
50647.LOG	10.000 - 100.000	-	3.1/2"	PT14	126	315	290	30.8
50820.LOGA	100 - 1.000	-	3/4" HD Type	PT1/PT1A/PT2	-	-	-	-
50821.LOGA	150 - 1.500	-	1" HD Type	PT1/PT1A/PT2	-	-	-	-
50822.LOGA	350 - 3.500	-	1"	HT5/PT5	-	-	-	-
50823.LOGA	500 - 5.000	-	1.1/2"	HT7/PT7	-	-	-	-
50824.LOGA	1.000 - 10.000	-	1.1/2"	HT9/PT9	-	-	-	-
50825.LOGA	2.000 - 20.000	-	2.1/2"	HT11/PT11	-	-	-	-
50826.LOGA	3.500 - 35.000	-	2.1/2"	HT12/PT12	-	-	-	-
50827.LOGA	5.000 - 50.000	-	2.1/2"	HT13/PT13	-	-	-	-
50828.LOGA	10.000 - 100.000	-	3.1/2"	HT14/PT14	-	-	-	-
50832.LOGA	15.000 - 150.000	-	4.1/2"	HT15/PT15	-	-	-	-
50829.LOGA	20.000 - 200.000	-	5"	HT16/PT16	-	-	-	-
50830.LOGA	25.000 - 250.000	-	6"	HT17/PT17	-	-	-	-
50831.LOGA	30.000 - 300.000	-	6"	HT18/PT18	-	-	-	-

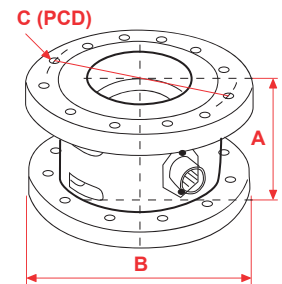
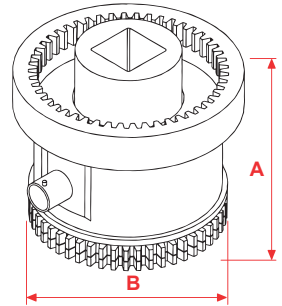
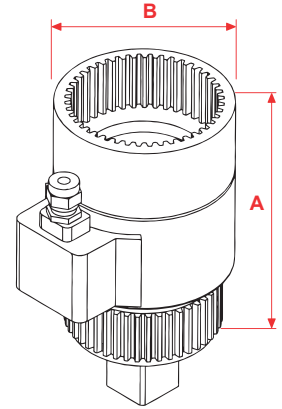

.LOGA modellerinde
açı ölçümü mevcuttur.

Angle measurement is available in
.LOGA models