



Sabit Tork Sensörleri

Smart Static Transducers



±% 0.5 Yüksek hassasiyetli tork ölçümü

100.000 N.m 0.1 - 100.000 N.m arası tork ölçüm imkanı

Class 1 BS7882:2008 standardında derecelendirme

N.m, Lbf.ft, Lbf.in, Ozf.in birimlerinde kalibrasyon

Farklı marka cihazlarla uyumludur

Her sensör kimlik çipine sahiptir

Burkulma dışı kuvvetler ölçümü etkilemez

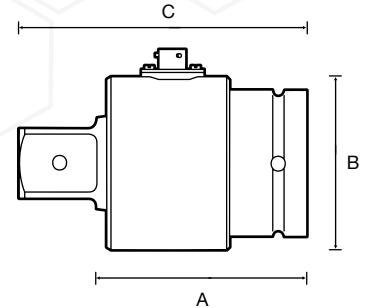
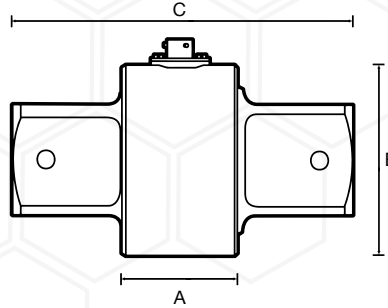
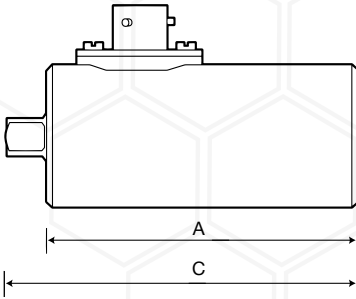

| Parça Part | Ölçüm Aralığı Measurement Range | Sürücü Drive | Burkulma Max. Torsion | Ölçüler (mm) Sizes | | | Ağırlık Weight |
|---------------|------------------------------------|-----------------|--------------------------|-----------------------|------|-------|-------------------|
| No. | N.m | inç | # | A | B | C | Kg |
| 50587.LOG * | 0.0 - 1.0 | 1/4" m/f | 150% | 79 | 36.5 | 86 | 0.45 |
| 50588.LOG | 0.25 - 2.5 | 1/4" m/f | 150% | 79 | 36.5 | 86 | 0.45 |
| 50589.LOG | 0.5 - 5 | 1/4" m/f | 150% | 79 | 36.5 | 86 | 0.45 |
| 50590.LOG | 1 - 10 | 1/4" m/f | 150% | 79 | 36.5 | 86 | 0.45 |
| 50591.LOG | 2.5 - 25 | 3/8" m/f | 150% | 79 | 36.5 | 89.5 | 0.45 |
| 50592.LOG | 5 - 50 | 3/8" m/f | 150% | 79 | 36.5 | 89.5 | 0.45 |
| 50593.LOG | 10 - 100 | 1/2" m/f | 150% | 79 | 36.5 | 92.8 | 0.46 |
| 50594.LOG | 25 - 250 | 1/2" m/f | 150% | 79 | 36.5 | 92.8 | 0.46 |
| 50701.LOG | 25 - 250 | 3/4" m/f | 150% | 118 | 54 | 141 | 1.5 |
| 50596.LOG | 50 - 500 | 3/4" m/f | 150% | 118 | 54 | 141 | 1.5 |
| 50772.LOG | 100 - 1.000 | 1" m/f | 150% | 118 | 54 | 146 | 1.6 |
| 50766.LOG | 150 - 1.500 | 1" m/f | 150% | 118 | 54 | 146 | 1.6 |
| 50703.LOG | 250 - 2.500 | 1.1/2" m/f | 150% | 117 | 95 | 160 | 4.6 |
| 50791.LOG | 300 - 3.000 | 1.1/2" m/f | 150% | 117 | 95 | 160 | 4.6 |
| 50599.LOG | 500 - 5.000 | 1.1/2" m/f | 150% | 117 | 95 | 160 | 4.6 |
| 50669.LOG | 700 - 7.000 | 1.1/2" m/f | 150% | 117 | 95 | 160 | 4.6 |
| 50776.LOG | 1.000 - 10.000 | 2.1/2" m/f | 150% | 145.5 | 130 | 209 | 9.2 |
| 50603.LOG | 2.500 - 25.000 | 2.1/2" m/m | 150% | 68.5 | 110 | 200 | 9 |
| 50797.LOG | 2.500 - 25.000 | 2.1/2" m/f | 150% | 145.5 | 130 | 209 | 9.5 |
| 50781.LOG | 5.000 - 50.000 | 2.1/2" m/f | 150% | 145.5 | 130 | 209 | 9.5 |
| 50794.LOG* | 5.000 - 50.000 | 3.1/2" m/m | 150% | 73.5 | 165 | 271 | 16.3 |
| 50783.LOG | 8.000 - 80.000 | 3.1/2" m/f | 150% | 205 | 160 | 291.5 | 16.5 |
| 50796.LOG | 10.000 - 100.000 | 3.1/2" m/f | 150% | 98 | 165 | 271 | 16.5 |

* TST, TTT, TTL-HE ile uyumlu olmayan modellerdir.