

**DYNAMOMETERS & LOAD CELLS**



**LARZEP advantages**

- Accuracy  $\pm 4\%$  full scale.
- From 5 to 100 Tn versions available for dynamometers, and from 5 to 150 Tn versions for load cells. Contact us for other capacities.
- Includes glycerine filled gauges with maximum indicating pointer.

**CT DYNAMOMETERS**

- Measure loads in compression.
- Can be used for measuring tension loads in cables, tensile testing and can be used as a weighing device.

**C LOAD CONTROL CELLS**

- Portable compression load cells, measure loads in compression.
- All references have remote mounted gauges with 0.8 metre hose, AP2008.

Larzep designs and manufactures special cylinders to place a load cell for pile testing.



DDR200015 cylinder. 2.000 Tn capacity cylinder to place a load cell for pile testing.

**CT - C**

5-150 Tn.

700 bar

TOOLS

**DYNAMOMETERS**

**CT**

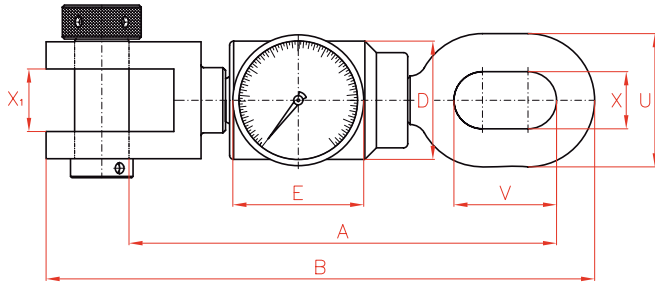

Capacity		Model	A	B	D	E	U	V	X	X1	Weight	Gauge	
Tn	kN	LARZEP	mm	mm	mm	mm	mm	mm	mm	mm	kg	Model	Scale (Tn)
5	49	CT00525	328	397	87	100	98	98	42	46	12,5	AX00510	0,05
10	98	CT01025	367	446	102	100	107	108	46	50	18,5	AX01010	0,1
30	303	CT03025	447	563	125	100	108	153	50	70	27,0	AX03010	0,3
50	486	CT05025	643	793	148	100	130	150	50	50	50,0	AX05010	0,5
100	1.026	CT10025	726	851	260	100	296	146	146	146	120,0	AX10010	1

**LOAD CELLS**

**C**

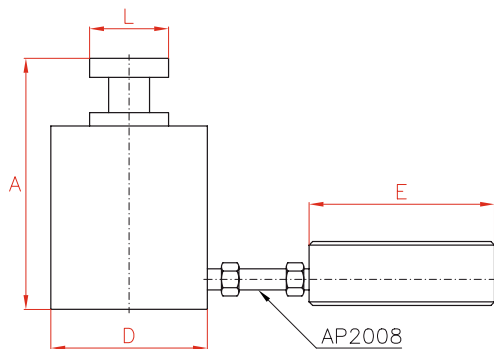

Remote mounted gauges with 0.8 metre hose, AP2008.

Capacity		Model	A	B	D	E	L	Weight	Gauge	
Tn	kN	LARZEP	mm	mm	mm	mm	mm	kg	Model	Scale (Tn)
5	44	C00510	39	-	60	100	25	1,9	AX00510	0,05
10	99	C01010	54	-	83	100	38	2,3	AX01010	0,1
30	287	C03010	72	-	114	100	60	4,8	AX03010	0,3
50	486	C05010	84	-	140	100	61	7,3	AX05010	0,5
100	953	C10010	103	-	178	100	88	15,7	AX10010	1
150	1.449	C15010	116	-	216	100	111	25,7	AX15010	1,5